

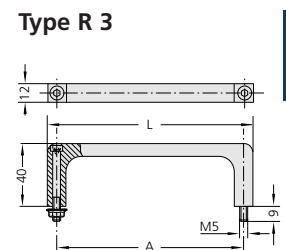

Description - Versatile and attractive handle suitable for rack mount equipment.
 Material - aluminium.
 Surface finish - matt anodised, white powder coated.

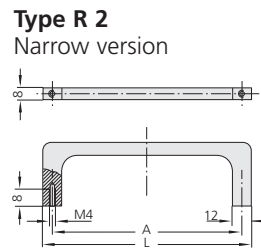

			Type R1	Type R2	Type R3
L	A	colour	Order no.	Order no.	Order no.
67	55	silver	R1-12.055.01	R2-08.055.01	R3-12.055.01
		black	R1-12.055.04	R2-08.055.04	R3-12.055.04
		white	R1-12.055.9002	-	-
100	88	silver	R1-12.088.01	R2-08.088.01	R3-12.088.01
		black	R1-12.088.04	R2-08.088.04	R3-12.088.04
		white	R1-12.088.9002	-	-
132	120	silver	R1-12.120.01	R2-08.120.01	R3-12.120.01
		black	R1-12.120.04	R2-08.120.04	R3-12.120.04
		white	R1-12.120.9002	-	-
192	180	silver	R1-12.180.01	R2-08.180.01	R3-12.180.01
		black	R1-12.180.04	R2-08.180.04	R3-12.180.04
		white	R1-12.180.9002	-	-
247	235	silver	R1-12.235.01	R2-08.235.01	R3-12.235.01
		black	R1-12.235.04	R2-08.235.04	R3-12.235.04
		white	R1-12.235.9002	-	-
43,5	32,0	silver	R1-12.032.01	R2-08.032.01	R3-12.032.01
		black	R1-12.032.04	R2-08.032.04	R3-12.032.0
87,5	75,5	silver	R1-12.075.01	R2-08.075.01	R3-12.075.01
		black	R1-12.075.04	R2-08.075.04	R3-12.075.04
132,0	120,0	silver	R1-12.120.01	R2-08.120.01	R3-12.120.01
		black	R1-12.120.04	R2-08.120.04	R3-12.120.04
265,5	253,5	silver	R1-12.253.01	R2-08.253.01	R3-12.253.01
		black	R1-12.253.04	R2-08.253.04	R3-12.253.04

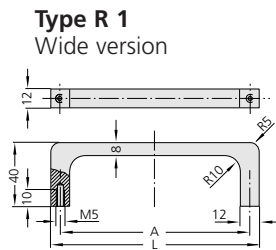

Description - Angled handle suitable for rack mount equipment.
 Material - aluminium.
 Surface finish - matt anodised, white powder coated.

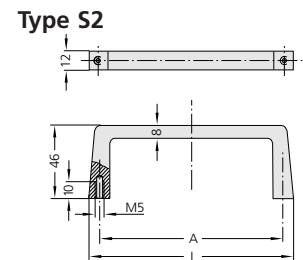
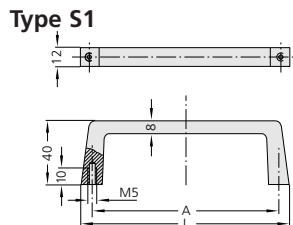

		silver	black	white	
Type	L	A	Order no.	Order no.	Order no.
S1	40	25	S1-12.025.01	S1-12.025.04	S1-12.025.9002
	69	55	S1-12.055.01	S1-12.055.04	S1-12.055.9002
	102	88	S1-12.088.01	S1-12.088.04	S1-12.088.9002
	134	120	S1-12.120.01	S1-12.120.04	S1-12.120.9002
	146,5	133,4	S1-12.133.01	S1-12.133.04	S1-12.133.9002
	191	177,8	S1-12.177.01	S1-12.177.04	S1-12.177.9002
S2	194	180	S1-12.180.01	S1-12.180.04	S1-12.180.9002
	249	235	S1-12.235.01	S1-12.235.04	S1-12.235.9002
	265,5	251,5	S1-12.251.01	S1-12.251.04	S1-12.251.9002
	102	88	S2-12.088.01	S2-12.088.04	-
	132	120	S2-12.120.01	S2-12.120.04	-
	265,5	251,5	S2-12.251.01	S2-12.251.04	-

All dimensions in mm.