

GK

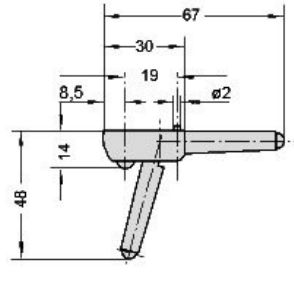

Description -Case foot with slip resistant insert.
Tilt extension leg snaps into position.
Material - Glass reinforced polyamide.
Surface finish- Fine grained.

Leg with lift lever



Leg without lift lever

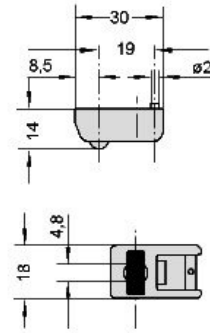

Description

Order No

2 Pcs with lift lever 2 Pcs without lift lever

GK-14.048.84S

4 Pcs without lift lever

GK-14.000.84S

GZ



Description - Highest quality case foot for The most demanding applications. Tilt leg Is locked into position, soft pvc inserts prevent slipping in both extended and collapsed position.
Material - Die cast zinc, polyamide locking bar, Soft pvc feet.
Finish - Fine texture painted.

Leg without Lift Lever

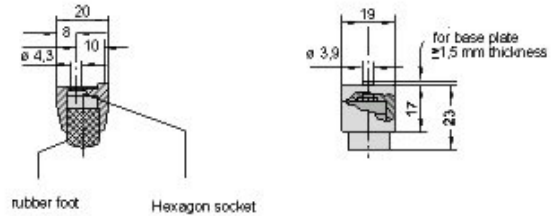

Leg with Lift Lever

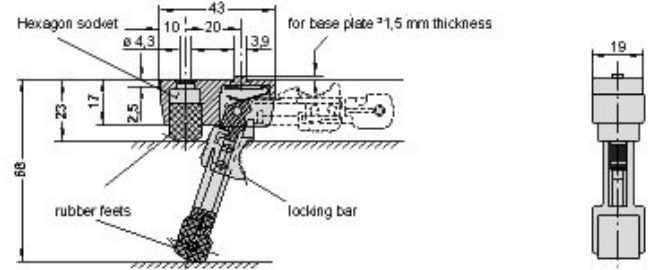

Description

Order No

Light Grey with lift lever

GZ-23.068.52

Black with lift lever

GZ-23.068.44

Light Grey without lift lever

GZ-23.000.52

Black without lift lever

GZ-23.000.44